

Lok-it! HTI 1500 W/60/P50

Lok-it! | HTI Short Arc Metal Halide lamps were designed as intense light sources primarily for moving head fixtures in the Entertainment marketplace.



Areas of application

- Concert lighting
- Club & Disco
- Stage and theatre
- Studio, TV and film
- Architecture & Architainment

Product family benefits

- Higher luminous efficacy than conventional HID lamps provides higher fixture efficiency
- Rapid relamping with bayonet lock

Product family features

- Compact design and short arc gap for use in smaller and brighter fixtures
- Fast lamp replacement with one touch thanks to rotating lock
- Robust design with eXtreme Seal (XS) technology, allowing up to 450°C at the pinch seal
- Consistent lumen output over the life of the lamp
- Ceramic base allows high voltage up to 35 kV

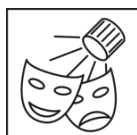

Product datasheet

Technical data

Electrical data

Nominal wattage	1500.00 W
Nominal voltage	100 V
Lamp voltage	100 V ¹⁾
Nominal current	15 A
Lamp current	15.0 A

¹⁾ ±10 V

Photometrical data

Nominal luminous flux	130000 lm
Color temperature	6000 K
Color rendering index Ra	>85

Dimensions & weight

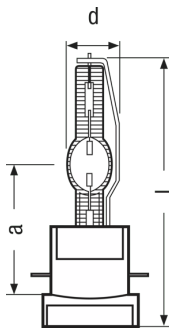

Diameter	29.0 mm
Length	128.0 mm
Light center length (LCL)	65.0 mm
Electrode gap cold	6.1 mm

Lifespan

Lifespan	750 h
----------	-------

Environmental information

Information according Art. 33 of EU Regulation (EC) 1907/2006 (REACH)	
Date of Declaration	05-03-2024
Primary Article Identifier	4008321553416 4052899561823

Product datasheet

Candidate List Substance 1	No declarable substances contained
Declaration No. in SCIP database	In work

Product datasheet

Safety advice

Because of their high luminance, UV radiation and high internal pressure during operation, Lok-it! lamps may only be operated in enclosed lamp casings specially constructed for the purpose. Appropriate filters must ensure that UV radiation is reduced to an acceptable level. Mercury is released if the lamp breaks. Special safety precautions must be taken. Information on safety and handling is available on request or can be found in the leaflet included with the lamp or in the operating instructions.

Logistical Data

Product code	Product description	Packaging unit (Pieces/Unit)	Dimensions (length x width x height)	Volume	Gross weight
4008321553416	Lok-it! HTI 1500 W/60/P50	Shipping carton box 1	115 mm x 82 mm x 305 mm	2.88 dm ³	249.00 g
4062172308199	Lok-it! HTI 1500 W/60/P50	Shipping carton box 10	- x - x -		

The mentioned product code describes the smallest quantity unit which can be ordered. One shipping unit can contain one or more single products. When placing an order, for the quantity please enter single or multiples of a shipping unit.

Disclaimer

Subject to change without notice. Errors and omission excepted. Always make sure to use the most recent release.
